



# BRAKE DISC

## 08.A915.10

**The 08.A915.10 brake disc is synonymous with reliability**

The Brembo brake disc is fully interchangeable with an Original Equipment brake disc. The control of the entire production cycle allows Brembo to offer brake discs with outstanding performance levels, reliability, durability and comfort in all conditions of use. All Brembo brake discs are accompanied by the ECE-R90 homologation.

- ✓ OE-equivalent
- ✓ Brembo quality
- ✓ ECE-R90 certificate
- ✓ Safety
- ✓ Fastening screws



### Technical specifications

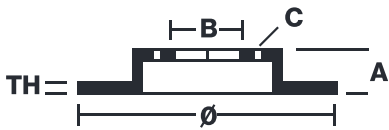

EAN code  
**8020584022542**

Axle  
**Rear**

Diameter Ø  
**251 mm**

Thickness (TH)  
**10 mm**

Height (A)  
**41 mm**

Number of holes (C)  
**4**

Brake disc type  
**Solid**

Centering (B)  
**59 mm**

Min. thickness  
**9 mm**

Tightening torque  
**98 Nm**

<b>08.A915.10</b>	
AP	14978 V-14978
BRECO	BV 7769-BS 7769
DIMENSION	251 x 10 mm
MIN TH	9 mm
BALANCING	GUARANTEED
MATERIAL	SUB-GROUP 1
WEIGHT	3.5 kg
EI1	90R
	02001202/25295
	INSIDE THE BOX
	205.5732.91
	08.A915.11

**COMPATIBLE VEHICLES**

## COMPATIBLE OE PART NUMBERS

51805559 ALFA ROMEO

---

51813705 ALFA ROMEO

---

51865104 ALFA ROMEO

---

51865132 ALFA ROMEO

---