



# BRAKE DISC

## 09.B461.10

The **09.B461.10** brake disc is synonymous with reliability

The Brembo brake disc is fully interchangeable with an Original Equipment brake disc. The control of the entire production cycle allows Brembo to offer brake discs with outstanding performance levels, reliability, durability and comfort in all conditions of use. All Brembo brake discs are accompanied by the ECE-R90 homologation.

- ✓ OE-equivalent
- ✓ Brembo quality
- ✓ ECE-R90 certificate
- ✓ Safety



### Technical specifications

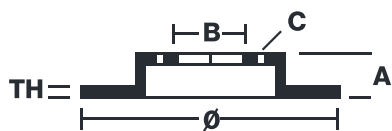

EAN code <b>8020584021811</b>	Axle <b>Front</b>	Diameter Ø <b>319</b> mm
Thickness (TH) <b>28</b> mm	Height (A) <b>67</b> mm	Number of holes (C) <b>6</b>
Brake disc type <b>Ventilated</b>	Centering (B) <b>108</b> mm	Min. thickness <b>26</b> mm
Tightening torque <b>112</b> Nm		

		<b>09.B461.10</b>	
AP	25273 V-25273		
BRECO	BV 8883-BS 8883		
DIMENSION	319 x 28 mm		
MIN TH	26 mm		
BALANCING	GUARANTEED		
MATERIAL	SUB-GROUP 1		
WEIGHT	8 kg		
E11	90R 02001202/25653		
<b>09.B461.11</b>			
DATE : 26/04/2016 VERSION : 01			

**COMPATIBLE VEHICLES**

## COMPATIBLE OE PART NUMBERS

4351204050	TOYOTA
------------	--------

4351204051	TOYOTA
------------	--------

4351204052	TOYOTA
------------	--------

435120K230	TOYOTA
------------	--------

4351235320	TOYOTA
------------	--------

4351235321	TOYOTA
------------	--------

4351235322	TOYOTA
------------	--------