



BRAKE DISC

09.B647.10

The **09.B647.10** brake disc is synonymous with reliability

The Brembo brake disc is fully interchangeable with an Original Equipment brake disc. The control of the entire production cycle allows Brembo to offer brake discs with outstanding performance levels, reliability, durability and comfort in all conditions of use. All Brembo brake discs are accompanied by the ECE-R90 homologation.

- ✓ OE-equivalent
- ✓ Brembo quality
- ✓ ECE-R90 certificate
- ✓ Safety
- ✓ PVT ventilation



Technical specifications

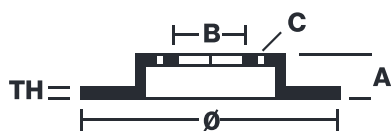

EAN code
8020584210833

Axle
Front

Diameter \varnothing
276 mm

Thickness (TH)
26 mm

Height (A)
46 mm

Number of holes (C)
5

Brake disc type
Ventilated

Centering (B)
69 mm

Min. thickness
24,4 mm

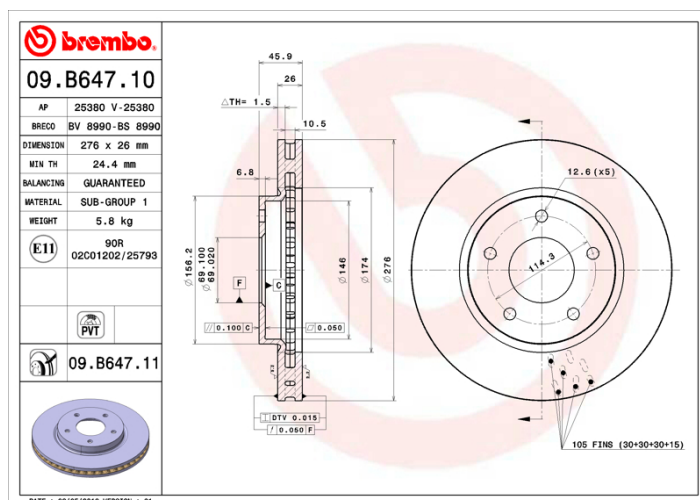

COMPATIBLE VEHICLES

COMPATIBLE OE PART NUMBERS

4615A115	MITSUBISHI
----------	------------

4615A190	MITSUBISHI
----------	------------

MN116329	MITSUBISHI
----------	------------

MN116330	MITSUBISHI
----------	------------

4615A115	PROTON
----------	--------

4615A190	PROTON
----------	--------
