



BRAKE PAD PRIME CERAMIC P85041N

The P85041N NAO brake pad is synonymous with reliability

Brembo NAO brake pads stand out for their ultimate braking comfort, reduced friction wear and low dust mission, which makes for cleaner rims and reduced maintenance requirements. The advanced friction material in keeping with the strictest environmental standards is the main distinguishing feature of NAO compounds.

- ✓ OE-equivalent
- ✓ Brembo quality
- ✓ Safety
- ✓ Comfort
- ✓ Durability
- ✓ Dust reduction
- ✓ With accessories



Technical specifications

EAN code 8020584100066	Axle Front	Thickness 20 mm
Width 146 mm	Height 55 mm	Braking system Teves
Wear indicator Without	WVA number 23130,23131	Accessories With piston clip With accessories With anti-squeal shim

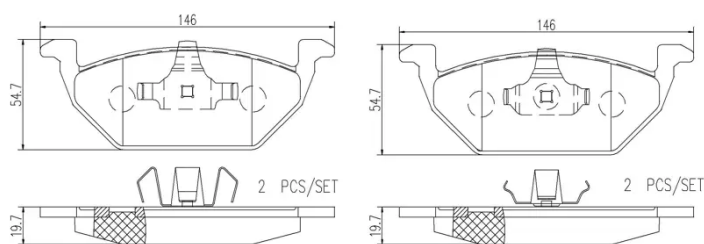

COMPATIBLE VEHICLES

COMPATIBLE OE PART NUMBERS

1J0615115	AUDI
-----------	------

1J0698151	AUDI
-----------	------

1J0698151A	AUDI
------------	------

1J0698151B	AUDI
------------	------

1J0698151C	AUDI
------------	------

1J0698151H	AUDI
------------	------

1J0698151J	AUDI
------------	------

1JE698151B	AUDI
------------	------

1KD698151	AUDI
-----------	------

1S0698151	AUDI
-----------	------

1S0698151A	AUDI
------------	------

1S0698151B	AUDI
------------	------

1S0698151C	AUDI
------------	------

5C0698151	AUDI
-----------	------

5Z0698151A	AUDI
------------	------

5Z0698151B	AUDI
------------	------

6C0698151	AUDI
-----------	------

6C0698151A	AUDI
------------	------

6C0698151B	AUDI
------------	------

6C0698151C	AUDI
------------	------

6Q0698151	AUDI
-----------	------

6R0698151A	AUDI
------------	------

6R0698151B	AUDI
------------	------

6RD698151A	AUDI
------------	------

JZW698151A	AUDI
------------	------

JZW698151AF	AUDI
-------------	------

B3501015EY	BESTURN (FAW)
------------	---------------

SHZ3501082	BRILLIANCE
------------	------------

1J0698151	SEAT
-----------	------

1J0698151A	SEAT
------------	------

1J0698151B	SEAT
------------	------

1J0698151C	SEAT
------------	------

1J0698151H	SEAT
------------	------

1J0698151J	SEAT
------------	------

1JE698151B	SEAT
------------	------

1KD698151	SEAT
-----------	------

1S0698151	SEAT
-----------	------

1S0698151A	SEAT
------------	------

1S0698151B	SEAT
------------	------

1S0698151C	SEAT
------------	------

2Q0698151	SEAT
-----------	------

5C0698151	SEAT
-----------	------

5Z0698151A	SEAT
------------	------

5Z0698151B	SEAT
------------	------

6C0698151	SEAT
-----------	------

6C0698151A	SEAT
6C0698151B	SEAT
6C0698151C	SEAT
6Q0698151	SEAT
6R0698151A	SEAT
6R0698151B	SEAT
6RD698151A	SEAT
JZW698151A	SEAT
JZW698151AF	SEAT
1J0698151	SKODA
1J0698151A	SKODA
1J0698151B	SKODA
1J0698151C	SKODA
1J0698151H	SKODA
1J0698151J	SKODA
1JE698151B	SKODA
1KD698151	SKODA
1S0698151	SKODA
1S0698151A	SKODA
1S0698151B	SKODA
1S0698151C	SKODA
2Q0698151T	SKODA
5C0698151	SKODA
5Z0698151A	SKODA
5Z0698151B	SKODA
6C0698151	SKODA
6C0698151A	SKODA
6C0698151B	SKODA
6C0698151C	SKODA
6C0698151D	SKODA
6Q0698151	SKODA
6R0698151A	SKODA
6R0698151B	SKODA
6RD698151	SKODA
6RD698151A	SKODA
JZW698151A	SKODA
JZW698151AF	SKODA
JZW698302CJ	SKODA
18D698151	SKODA (SVW)
1KD698151	SKODA (SVW)
6RD698151	SKODA (SVW)
6RD698151B	SKODA (SVW)
180698151A	VW
180698151B	VW
1J0698151	VW
1J0698151A	VW
1J0698151B	VW
1J0698151C	VW

1J0698151H	VW
1J0698151J	VW
1JE698151	VW
1JE698151B	VW
1KD698151	VW
1S0698151	VW
1S0698151A	VW