



BRAKE DISC

08.4738.14

The **08.4738.14** brake disc is synonymous with reliability

The Brembo brake disc is fully interchangeable with an Original Equipment brake disc. The control of the entire production cycle allows Brembo to offer brake discs with outstanding performance levels, reliability, durability and comfort in all conditions of use. All Brembo brake discs are accompanied by the ECE-R90 homologation.

- ✓ OE-equivalent
- ✓ Brembo quality
- ✓ ECE-R90 certificate
- ✓ Safety
- ✓ Fastening screws



Technical specifications

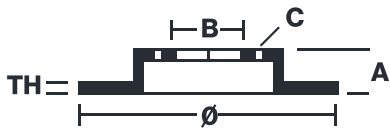

EAN code **8020584012789** Axle **Front and rear**

Thickness (TH) **9 mm** Height (A) **54 mm**

Brake disc type **Solid** Centering (B) **67 mm**

Tightening torque **120 Nm**

Diameter \varnothing **258 mm**

Number of holes (C) **5**

Min. thickness **7,3 mm**

08.4738.14	
AP	10276 E
BRECO	BS 7338
DIMENSION	258 x 9 mm
MIN TH	7,3 mm
MAX DIA	185 mm
BALANCING	GUARANTEED
MATERIAL	SUB-GROUP 1
WEIGHT	3,2 kg
	DP
	KBA 00439
	INSIDE THE BOX 105.5732.94

DATE : 26/12/2010 VERSION : 00

COMPATIBLE VEHICLES

COMPATIBLE OE PART NUMBERS

2014230912	MERCEDES-BENZ
------------	---------------

2014231112	MERCEDES-BENZ
------------	---------------

2014231212	MERCEDES-BENZ
------------	---------------

A2014230912	MERCEDES-BENZ
-------------	---------------

A2014231112	MERCEDES-BENZ
-------------	---------------

A2014231212	MERCEDES-BENZ
-------------	---------------
