



BRAKE DISC

09.B520.10

The **09.B520.10** brake disc is synonymous with reliability

The Brembo brake disc is fully interchangeable with an Original Equipment brake disc. The control of the entire production cycle allows Brembo to offer brake discs with outstanding performance levels, reliability, durability and comfort in all conditions of use. All Brembo brake discs are accompanied by the ECE-R90 homologation.

- ✓ OE-equivalent
- ✓ Brembo quality
- ✓ ECE-R90 certificate
- ✓ Safety
- ✓ High carbon

Technical specifications

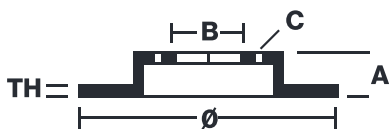

EAN code	Axle	Diameter Ø
8020584230503	Front	275 mm
Thickness (TH)	Height (A)	Number of holes (C)
25 mm	46 mm	5
Brake disc type	Centering (B)	Min. thickness
Ventilated	62 mm	22 mm

COMPATIBLE VEHICLES

COMPATIBLE OE PART NUMBERS

4351242040	LEXUS
4351242040	TOYOTA
4351242080	TOYOTA