



# BRAKE DISC

## 08.2631.30

The **08.2631.30** brake disc is synonymous with reliability

The Brembo brake disc is fully interchangeable with an Original Equipment brake disc. The control of the entire production cycle allows Brembo to offer brake discs with outstanding performance levels, reliability, durability and comfort in all conditions of use. All Brembo brake discs are accompanied by the ECE-R90 homologation.

- ✓ OE-equivalent
- ✓ Brembo quality
- ✓ ECE-R90 certificate
- ✓ Safety
- ✓ Fastening screws

### Technical specifications

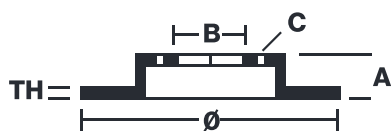

EAN code	Axle	Diameter Ø
-	<b>Front and rear</b>	<b>239</b> mm
Thickness (TH)	Height (A)	Number of holes (C)
<b>10</b> mm	<b>39</b> mm	<b>4</b>
Brake disc type	Centering (B)	Min. thickness
<b>Solid</b>	<b>65</b> mm	<b>8</b> mm
Tightening torque		
<b>120</b> Nm		

COMPATIBLE VEHICLES

## COMPATIBLE OE PART NUMBERS

811615301	AUDI
-----------	------

---

811615301B	AUDI
------------	------

---

823615301	AUDI
-----------	------

---

811615301	SEAT
-----------	------

---

811615301B	SEAT
------------	------

---

811615301	VW
-----------	----

---

811615301B	VW
------------	----

---

823615301	VW
-----------	----

---