



# BEYOND GREENANCE KIT KT 10 002

## Greenance Kit KT 10 002: fewer emissions and lower maintenance costs

The Greenance Kit consists of a brake disc and a brake pad made with latest-generation materials. It is Brembo's new solution to reduce fine particulate emissions (PM10 and PM2.5) and to prolong the life of components, while retaining the superior performance levels of all Brembo products. Brembo Beyond Greenance Kit combines superior braking performance with a smaller environmental footprint, while at the same time prolonging the durability of brake discs and lowering maintenance costs.



- ✓ Brembo quality
- ✓ ECE-R90 certificate
- ✓ Comfort
- ✓ Durability
- ✓ Dust reduction
- ✓ Anti-corrosion
- ✓ Kit
- ✓ Green packaging

### Kit information

|                      |                     |                    |
|----------------------|---------------------|--------------------|
| EAN code             | Brake discs per box | Brake pads per box |
| <b>8432509503447</b> | <b>2</b>            | <b>4</b>           |

Axle  
Front and rear

### Brake disc technical specifications

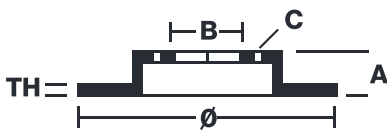

|               |                |                |
|---------------|----------------|----------------|
| Diameter      | Thickness (TH) | Height (A)     |
| <b>280 mm</b> | <b>28 mm</b>   | <b>71,5 mm</b> |

|                     |                 |               |
|---------------------|-----------------|---------------|
| Number of holes (C) | Brake disc type | Centering (B) |
| <b>5</b>            | <b>Solid</b>    | <b>73 mm</b>  |

Min. thickness

with thickness  
**25,9** mm

## Brake pad technical specifications

|                |                 |                    |
|----------------|-----------------|--------------------|
| Thickness      | Width           | Height             |
| <b>28</b> mm   | <b>169</b> mm   | <b>62</b> mm       |
| Braking system | Wear indicator  | WVA number         |
| <b>Brembo</b>  | <b>Electric</b> | <b>24468,24469</b> |

### Accessories

**With accessories**  
**With brake caliper**  
**bolts**

**COMPATIBLE VEHICLES**