



# BRAKE PAD XTRA CERAMIC P50122NX

**Xtra Ceramic brake pad P50122NX belongs to Brembo Cool Line**

Brembo Xtra Ceramic brake pads have a specific compound which, beside being copper free, also contains less metal compared to Xtra pads. This feature make Xtra Ceramic more focused on comfort and cleaner rims, thanks to the ceramic friction material, while guaranteeing the top performance proper of the Xtra line. Xtra Ceramic range is fully ECE R90 homologated.

- ✓ OE-equivalent
- ✓ Brembo quality
- ✓ ECE-R90 certificate
- ✓ Safety
- ✓ Performance
- ✓ Dust reduction
- ✓ Comfort

## Technical specifications

EAN code	Axle	Thickness
<b>8020584131497</b>	<b>Rear</b>	<b>16 mm</b>
Width	Height	Braking system
<b>123 mm</b>	<b>56 mm</b>	<b>Teves</b>
Wear indicator	WVA number	Accessories
<b>Prepared for wear indicator</b>	<b>25353,25354</b>	<b>With anti-squeal shim</b>

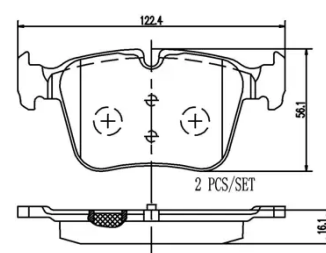
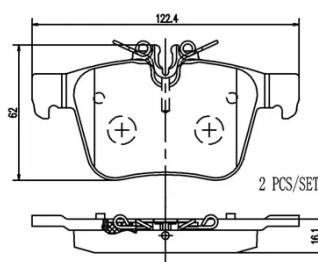

**COMPATIBLE VEHICLES**

# COMPATIBLE OE PART NUMBERS

0084201420	MERCEDES-BENZ
A0004208603	MERCEDES-BENZ
A0084201420	MERCEDES-BENZ