



# BRAKE DISC

## 08.B357.10

The **08.B357.10** brake disc is synonymous with reliability

The Brembo brake disc is fully interchangeable with an Original Equipment brake disc. The control of the entire production cycle allows Brembo to offer brake discs with outstanding performance levels, reliability, durability and comfort in all conditions of use. All Brembo brake discs are accompanied by the ECE-R90 homologation.

- ✓ OE-equivalent
- ✓ Brembo quality
- ✓ ECE-R90 certificate
- ✓ Safety
- ✓ Fastening screws



### Technical specifications

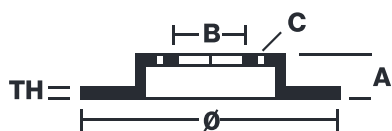

EAN code  
**8020584028421**

Axle  
**Rear**

Diameter  $\varnothing$   
**268 mm**

Thickness (TH)  
**12 mm**

Height (A)  
**45 mm**

Number of holes (C)  
**5**

Brake disc type  
**Solid**

Centering (B)  
**60 mm**

Min. thickness  
**10 mm**

Tightening torque  
**110 Nm**

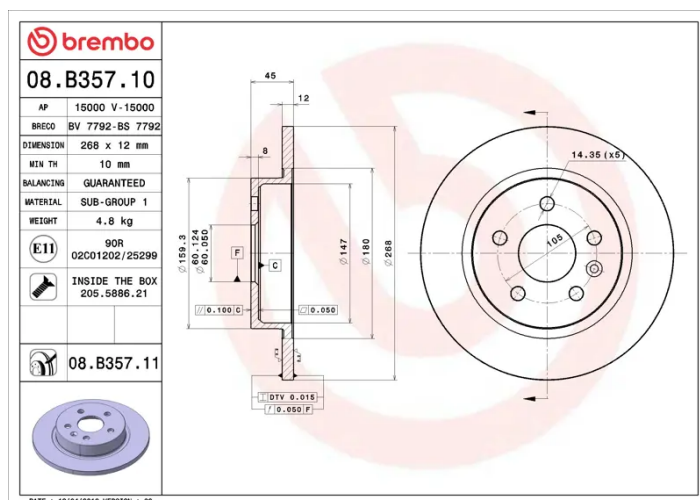

COMPATIBLE VEHICLES

## COMPATIBLE OE PART NUMBERS

13502135 BUICK (SGM)

---

13502136 BUICK (SGM)

---

13502134 CHEVROLET

---

13502135 CHEVROLET

---

13502136 CHEVROLET

---

13502864 CHEVROLET

---

13505759 CHEVROLET

---

23118283 CHEVROLET

---

13502135 CHEVROLET (SGM)

---

13502136 CHEVROLET (SGM)

---

13502134 OPEL

---

13502135 OPEL

---

569072 OPEL

---

569074 OPEL

---

95527032 OPEL

---

13502134 VAUXHALL

---

13502135 VAUXHALL

---

95527032 VAUXHALL

---