



CLUTCH MASTER CYLINDER

M 06 030

The M 06 030 brake master cylinder is synonymous with reliability

For the braking system to work well, all the components of the brake master cylinder must meet the highest standards of quality and strength. All Brembo brake master cylinders are subjected to complete in-line checks which guarantee conformity to the strictest standards.

- ✓ OE-equivalent
- ✓ Brembo quality
- ✓ Safety
- ✓ Durability
- ✓ Durability test
- ✓ Tightness test
- ✓ Burst test

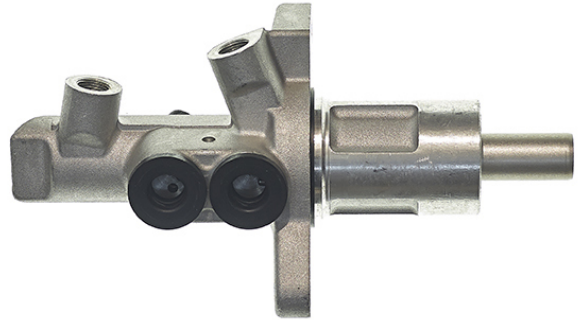

Technical specifications

EAN code
8432509652930

Axle

Threading
12 x 1 (2)

Braking system
ATE

Material
Aluminium

COMPATIBLE OE PART NUMBERS

34316764131	BMW
34336779720	BMW
34336785664	BMW
6764131	BMW
6779720	BMW
6785664	BMW