



# BRAKE DISC PAINTED

## 09.A386.11

The 09.A386.11 painted brake disc is synonymous with reliability

The Brembo brake disc with special UV paint treatment guarantees superior corrosion resistance for the product, thanks to the protective coating on the outer edges and on the disc hub. The UV paint not only gives the disc a clean, shiny appearance but is also beneficial for the environment as the water-based UV paint treatment does not require the use of chemical solvents and is a low energy consumption process.

- ✓ OE-equivalent
- ✓ Brembo quality
- ✓ ECE-R90 certificate
- ✓ Safety
- ✓ Anti-corrosion



### Technical specifications

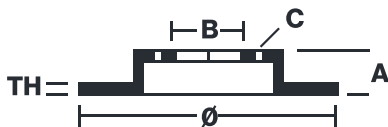

EAN code  
**8020584031414**

Axle  
**Front**

Diameter Ø  
**275 mm**

Thickness (TH)  
**28 mm**

Height (A)  
**49 mm**

Number of holes (C)  
**5**

Brake disc type  
**Ventilated**

Centering (B)  
**62 mm**

Min. thickness  
**26 mm**

Tightening torque  
**103 Nm**

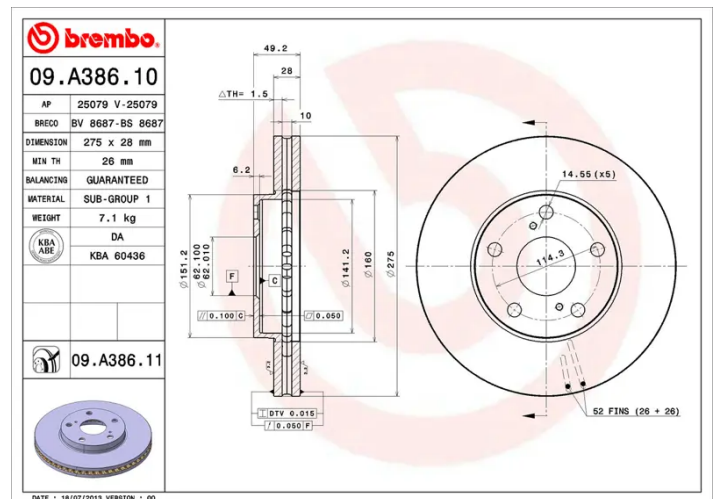

COMPATIBLE VEHICLES

# COMPATIBLE OE PART NUMBERS

4351233040	LEXUS
4351233041	LEXUS
4351233042	LEXUS
4351233043	LEXUS
4351233060	LEXUS
4351206020	TOYOTA
4351206030	TOYOTA
4351206031	TOYOTA
4351206040	TOYOTA
4351207020	TOYOTA
4351208020	TOYOTA
4351208021	TOYOTA
4351233040	TOYOTA
4351233041	TOYOTA
4351233042	TOYOTA
4351233043	TOYOTA
4351233060	TOYOTA
4351233070	TOYOTA
4351233080	TOYOTA
4351233090	TOYOTA
4351244010	TOYOTA
4351244011	TOYOTA
4351244020	TOYOTA
4351244021	TOYOTA