



BEYOND GREENANCE KIT KT 10 004

Greenance Kit KT 10 004: fewer emissions and lower maintenance costs

The Greenance Kit consists of a brake disc and a brake pad made with latest-generation materials. It is Brembo's new solution to reduce fine particulate emissions (PM10 and PM2.5) and to prolong the life of components, while retaining the superior performance levels of all Brembo products. Brembo Beyond Greenance Kit combines superior braking performance with a smaller environmental footprint, while at the same time prolonging the durability of brake discs and lowering maintenance costs.



- ✓ Brembo quality
- ✓ ECE-R90 certificate
- ✓ Comfort
- ✓ Durability
- ✓ Dust reduction
- ✓ Anti-corrosion
- ✓ Kit
- ✓ Green packaging

Kit information

EAN code Brake discs per box Brake pads per box
8432509503461 **2** **4**

Axle
 Front and rear

Brake disc technical specifications

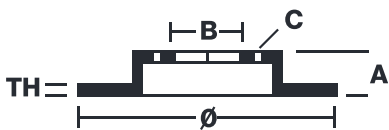

Diameter	Thickness (TH)	Height (A)
280 mm	16 mm	82 mm
Number of holes (C)	Brake disc type	Centering (B)
5	Solid	79 mm

Min. thickness

		08.8094.4G																					
<table border="0"> <tr> <td>DIMENSION</td> <td>280 x 16 mm</td> </tr> <tr> <td>MIN TH</td> <td>14.2 mm</td> </tr> <tr> <td>MAX DIA</td> <td>173 mm</td> </tr> <tr> <td>BALANCING</td> <td>GUARANTEED</td> </tr> <tr> <td>MATERIAL</td> <td>SUB-GROUP 2</td> </tr> <tr> <td>WEIGHT</td> <td>7.35 kg</td> </tr> <tr> <td>E11</td> <td>90R</td> </tr> <tr> <td>INSIDE THE BOX</td> <td>205.5732.91</td> </tr> <tr> <td>HC</td> <td></td> </tr> <tr> <td></td> <td>08.8094.4G</td> </tr> </table>				DIMENSION	280 x 16 mm	MIN TH	14.2 mm	MAX DIA	173 mm	BALANCING	GUARANTEED	MATERIAL	SUB-GROUP 2	WEIGHT	7.35 kg	E11	90R	INSIDE THE BOX	205.5732.91	HC			08.8094.4G
DIMENSION	280 x 16 mm																						
MIN TH	14.2 mm																						
MAX DIA	173 mm																						
BALANCING	GUARANTEED																						
MATERIAL	SUB-GROUP 2																						
WEIGHT	7.35 kg																						
E11	90R																						
INSIDE THE BOX	205.5732.91																						
HC																							
	08.8094.4G																						

with thickness
14,2 mm

DATE : 16/07/2022 VERSION : 00

Brake pad technical specifications

Thickness	Width	Height
16 mm	137 mm	49 mm
Braking system	Wear indicator	WVA number
Bosch	Electric	22041,24465

Accessories

With accessories
With brake caliper
bolts

COMPATIBLE VEHICLES