



BRAKE DISC

08.5444.10

The **08.5444.10** brake disc is synonymous with reliability

The Brembo brake disc is fully interchangeable with an Original Equipment brake disc. The control of the entire production cycle allows Brembo to offer brake discs with outstanding performance levels, reliability, durability and comfort in all conditions of use. All Brembo brake discs are accompanied by the ECE-R90 homologation.

- ✓ OE-equivalent
- ✓ Brembo quality
- ✓ ECE-R90 certificate
- ✓ Safety
- ✓ Fastening screws



Technical specifications

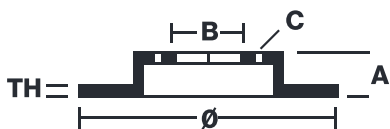

EAN code
8020584544419

Axle
Front

Diameter \varnothing
303 mm

Thickness (TH)
16 mm

Height (A)
83 mm

Number of holes (C)
5

Brake disc type
Solid

Centering (B)
85 mm

Min. thickness
13 mm

Tightening torque
120 Nm

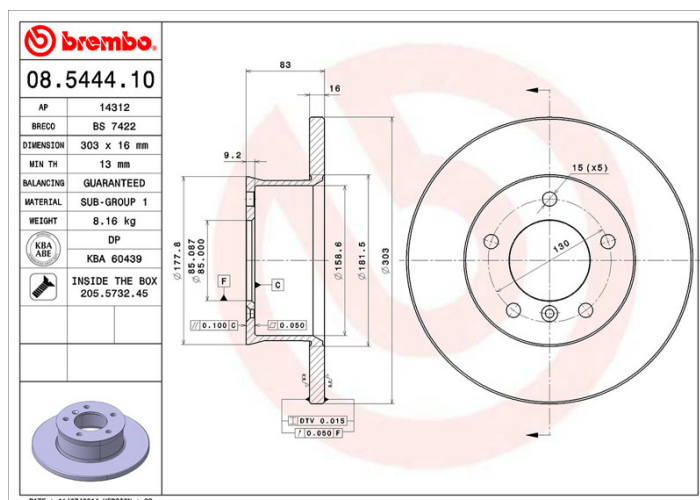

COMPATIBLE VEHICLES

COMPATIBLE OE PART NUMBERS

4604210012	MERCEDES-BENZ
------------	---------------

4604210112	MERCEDES-BENZ
------------	---------------

4614210012	MERCEDES-BENZ
------------	---------------

A4604210012	MERCEDES-BENZ
-------------	---------------

A4614210012	MERCEDES-BENZ
-------------	---------------

4604210012	PUCH
------------	------
