



BRAKE DISC

08.7072.10

The 08.7072.10 brake disc is synonymous with reliability

The Brembo brake disc is fully interchangeable with an Original Equipment brake disc. The control of the entire production cycle allows Brembo to offer brake discs with outstanding performance levels, reliability, durability and comfort in all conditions of use. All Brembo brake discs are accompanied by the ECE-R90 homologation.

- ✓ OE-equivalent
- ✓ Brembo quality
- ✓ ECE-R90 certificate
- ✓ Safety



Technical specifications

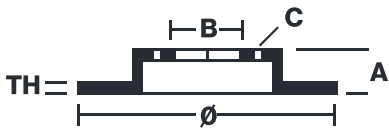

EAN code 8020584707210	Axle Front	Diameter Ø 234 mm
Thickness (TH) 13 mm	Height (A) 34 mm	Number of holes (C) 4
Brake disc type Solid	Centering (B) 86 mm	Min. thickness 11,4 mm

		08.7072.10	
AP	14685		
BRECO	BS 7548		
DIMENSION	234 x 13 mm		
MIN TH	11.4 mm		
BALANCING	GUARANTEED		
MATERIAL	SUB-GROUP 1		
WEIGHT	3.5 kg		
E11	90R 02C01202/25291		
DATE : 12/04/2016 VERSION : 01			

COMPATIBLE VEHICLES

COMPATIBLE OE PART NUMBERS

MB618736	DODGE
----------	-------

MB618737	DODGE
----------	-------

MB618736	MITSUBISHI
----------	------------

MB618737	MITSUBISHI
----------	------------

MB618736	PROTON
----------	--------

MB618737	PROTON
----------	--------
