

FITTING INSTRUCTIONS

We have included a specific mounting instruction to ensure that the products are assembled in the correct way. Please ensure when fitting new pads, the clips are removed and the caliper carrier is cleaned thoroughly and then a very thin layer of non-metallic lubricant grease is applied at a and b. Do not use copper grease for this purpose. When possible, fit new clips as tension is vastly reduced after 1 year of wear. Please see the instruction below:

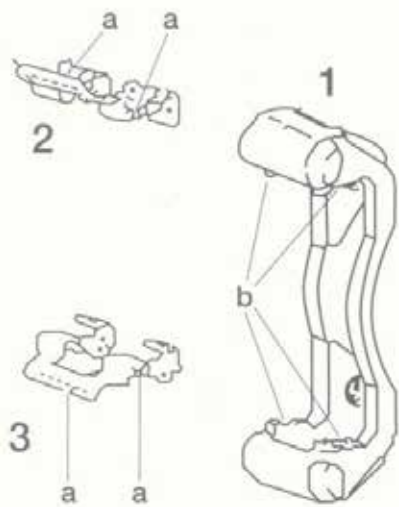

Bitte beachten Sie die folgenden Hinweise bei jedem Belag Wechsel
Please follow the instruction sat each brake pad change

Entfernen Sie vorsichtig die Bleche 2 + 3 aus dem Bremsträger 1
Remove carefully the shims 2 + 3 from the brake anchor 1

Reinigen Sie die Flächen a + b von Schmutz und Rost
Clean up the surfaces a + b from dirt and corrosion

Fetten Sie die Flächen a mit Plastilube leicht ein
Put grease Plastilube tot the surfaces a

Setzen Sie die Bleche 2 + 3 wieder in den Bremsträger 1 ein.
Achten Sie darauf, dass die Bleiche fest sitzen
Fit the shims 2 + 3 into the brake anchor 1.
Take care that the shims have full contact to the brake anchor.